

Keylock (Entry)
1740 (Premiere)

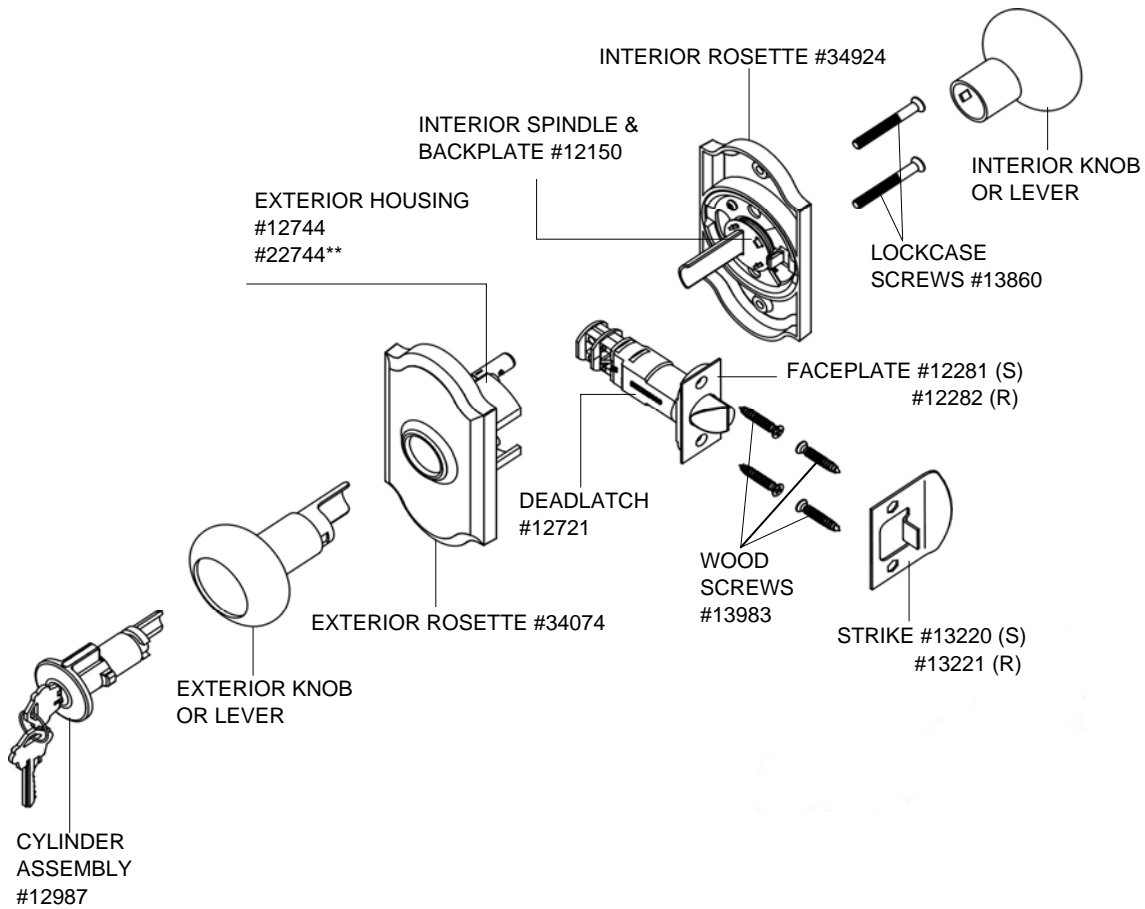

Note: Exterior Housing and Interior Spindle & Backplate accommodates standard door thickness 1 3/8" to 1 3/4" (35-44 mm)

** Housing Assembly for all Lever Keylocks

* Finishes available: (N, 1, P)

Cylinder Assembly			Latch & Strike Screws		
Assembly	Knob 12987	Lever 12292	Wood Door & Jamb	13983	
			Metal Door	13903	
			Metal Jamb	13902	
Deadlatch			Knob & Lever Styles		
Convertible Backset 2 3/8" to 2 3/4" (60-70 mm)	Knob 12721	Lever 32721	Interior	Knob/Lever Style	Ext. Keylock
			12013	Impresa Knob	12016
			12017	Julienne Knob	12021
			20066	**Right Hand Bordeaux Lever	20071
			20065	**Left Hand Bordeaux Lever	20072
			26050	**Non-Handed Legacy Lever	26053