

Specifications

Schwinn Series 34026; Schwinn Item 34026 Knob - VBD

Design: Michael Graves



Application

Drawer/Cabinet Knob

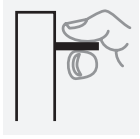

Characteristics

Material: Steel/Brass/Furniture Linoleum

Finish: Plated, Brushed

Weight: 20 g (0.71 oz)

Dimensions: 29 x 29 mm

C/C 0; M4 Thread

Care: Damp, non-abrasive cloth with mild soap only.

Finish Options

Polished Chrome/Dark Blue Linoleum - Order Nr. 60171

Polished Chrome/Burgundy Linoleum - Order Nr. 60173

Brushed Brass/Dark Blue Linoleum - Order Nr. 60172

Brushed Brass/Burgundy Linoleum - Order Nr. 60174

Environmental

- Fully Recyclable

- Meets RoHS Standards

ADA Compliant: Yes

Warranty

Limited lifetime.

Designer

Michael Graves (1934-2015) started as a professor of architecture in 1962 at Princeton University and spent much of the late 1960s and early 1970s designing modern residences. In the late 1970s, Graves shifted away from modernism to pursue Postmodernism and New Urbanism. Postmodernism allowed Graves to introduce his humanist vision of classicism, as well as his sense of irony and humor. He also designed numerous household products for Target and other corporations. Most famous is his 1985-designed iconic stainless steel tea kettle featuring a red bird-shaped whistle at the end of the spout.

© Michael Graves, Schwinn under license.

